



Elmhurst Community Unit School District 205

Facilities at a Glance

2015-2016

**Elmhurst Community Unit
School District 205**
District 205 Center
162 S. York
Elmhurst, IL 60126
www.elmhurst205.org
630/834-4530

District 205 Fast Facts

Total students..... 8,331

Total schools.....14

Early childhood/preschool.....1

Elementary schools.....8

Middle schools.....3

High school.....1

Transition Program.....1

Total employees.....1,160

Administrators.....38

Full-time teachers.....645

Part-time teachers.....31

Teachers with

advanced

degrees.....78.4%

(State average is 61.1%)

Support staff.....446

(Including educational and
instructional assistants, office
personnel and custodial/
maintenance workers)

District 205 encompasses a total of
125 acres and 1.5 million square
feet in 15 buildings (includes
Administrative Center).

Area of coverage..... 40 sq. miles
Including most of Elmhurst
and portions of Addison,
Bensenville and Oak Brook

Certified staff to
student ratio*..... 12.3 to 1
(State is 11.3 to 1)

Elementary (PreK-8).....15.4 to 1
(State is 18.5 to 1)

Secondary (9-12)..... 17.9 to 1
(State is 18.4 to 1)

Administrator.....210.6 to 1
(State is 173.3 to 1)

** Taken from the 2014-15 Illinois State
Report Card for Elmhurst Community
Unit School District 205*

This booklet was prepared by the Elmhurst Community Unit School District 205 Finance and Operations Department in collaboration with the Communications Department for the benefit of our community. It presents an overview of the facilities for fiscal year 2015-16.

Christopher Whelton
Assistant Superintendent for Finance and Operations
cwhelton@elmhurst205.org

Table of Contents

Introduction

A Letter from the Superintendent.....	3
Board of Education.....	4

Early Childhood Center

Madison Early Childhood Education Center	5-6
--	-----

Elementary Schools

Edison Elementary School.....	7-8
Emerson Elementary School.....	9-10
Field Elementary School.....	11-12
Fischer Elementary School	13-14
Hawthorne Elementary School.....	15-16
Jackson Elementary School.....	17-18
Jefferson Elementary School.....	19-20
Lincoln Elementary School	21-22

Middle Schools

Bryan Middle School	23-24
Churchville Middle School	25-26
Sandburg Middle School.....	27-28

High School

York Community High School	29-30
Facility Highlights	31
Capital Improvements	32
Boundaries.....	33

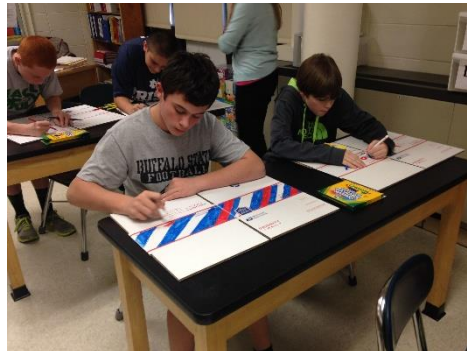

From Superintendent of Schools David Moyer

Dear Friends and Colleagues,

Elmhurst Community Unit School District 205 is proud to be home to five National Blue Ribbon schools and 23 National Board Certified teachers. York Community High School offers 70 sports and clubs, and over 77% of students participate in one or more school-related activities. In the fall of 2015, District 205 announced three National Merit Semifinalists, 12 Commended Students and 27 AP Scholars.



York and Indiana University have formed a dual credit partnership called The Advanced College Project (ACP). ACP provides York students with college level coursework while in high school. Upon successful completion of an ACP course, a student receives both high school credit, as well as credit for the identical course at Indiana University. York is the only high school in Illinois to offer this opportunity.

Accomplishments such as these are not possible without strong community support for public education. I am proud to serve in Elmhurst, a community which clearly values and supports its public schools.

The District is committed to involving the community in the educational process and goes to great lengths to do so. Board meetings are televised, the District is hosting a Community Engagement process called Focus 205, and I regularly host superintendent coffees in partnership with the District PTA Council. The Board of Education annually visits schools on a rotating basis to become more familiar with the educational process. I am an ex-officio member of the Chamber of Commerce Board of Directors and attend many community functions. These are just a few examples.

Studies have shown that the quality of the learning environment – everything from lighting to air quality to ventilation and temperature – have a direct effect on student performance. As we focus on increasing the engagement and achievement of our students, preparing them to be college and career ready, we must simultaneously look to the future and plan for the long-term viability of our facilities.

The District's finances are on solid footing, but uncertainty in funding and policy at the state level, combined with a slow economic recovery, may present future challenges. District administration monitors these factors closely to help ensure long-term financial sustainability for our schools and, ultimately, the communities we serve.

Sincerely,

A handwritten signature in black ink, appearing to read "David Moyer", written in a cursive style.

Dr. David A. Moyer
Superintendent of Schools

Elmhurst Community Unit School District 205 Board of Education



Shannon Ebner
Elected April 2011
Current Board President
Committee Assignments:
Board Improvement
Current Term 2015-2019
Liaison to Fischer & Emerson



Emily Bastedo
Elected April 2013
Committee Assignments:
Finance and Operations
Policy Committee
Current Term 2013-2017
Liaison to Jefferson & Sandburg



Jim Collins
Elected April 2009
Current Board Vice President
Committee Assignments:
Learning & Teaching
Board Improvement Committee
Performance Management
Current Term 2013-2017
Liaison to Jackson & Hawthorne



Chris Blum
Elected April 2011
Committee Assignments:
Finance & Operations
Performance Management
Member of the City/Park/School
Intergovernmental Committee
Current Term 2015-2019
Liaison to Field & York



Karen Stuefen
Elected April 2011
Current Board Secretary
Board Representative for LEND
(the Legislative Education
Network of DuPage County)
Committee Assignments:
Board Improvement
Performance Management
Finance & Operations
Current Term 2015-2019
Liaison to Bryan & Lincoln



Margaret Harrell
Elected April 2013
Board Representative for Illinois
Association of School Board
(IASB)
Committee Assignments:
Learning & Teaching
Policy Committee
Current Term 2013-2017
Liaison to Edison & Madison

Meeting Information

Meetings are generally held twice a month, on the second and fourth Tuesdays at 7:30 p.m.

A complete schedule of meetings is available on the district website at

www.elmhurst205.org/audio



John McDonough
Elected April 2011
Board Representative for the
Lizzadro Museum
Committee Assignments:
Learning & Teaching
Policy Committee
Member of the City/Park/School
Intergovernmental Committee
Current Term 2015-2019
Liaison to Churchville & York

Madison Early Childhood Education Center

130 W. Madison • Elmhurst, IL 60126 • (630) 617-2385 • <http://mecc.elmhurst205.org>

Built in 1958

Sq. Footage	Classrooms	Gyms/Multipurpose	Auditorium	Cafeteria	LRC/TRC	# of students
31,178	14	1	Stage in Gym	N/A	N/A	248

Total Acres	Acres/Playable fields	Lawns	Acres/blacktop play area	Athletic Fields	Linear Feet of Sidewalk	Parking Spots
4.0	1.2	2	N/A	1 small soccer field	2341	83

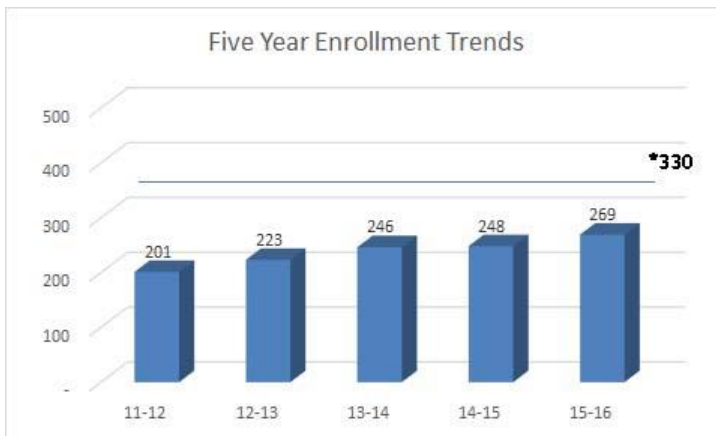

* **Capacity figures** based on national norms which are established by dividing the total square footage by # of students (ES = 120ft²)

	Type	Age	Condition
Heating	2 hot water boilers	58 years old	Good
Air-conditioning	Window Units	Variable	Variable
Electrical Service	1000 amp 208/120 service	22 years old	Excellent
Plumbing	Galvanized pipe	58 years old Some runs and fittings replaced 7 years ago	Poor
Fire Suppression	Not Sprinkled		
Roof	All roofs are in very good condition		
Building Envelope	12,650 ft ² of masonry restoration needed		

Highlights

- Adequate space for special programming
- Large gym for gross motor skills
- Library & Reading room
- Small soccer field will soon provide storm detention for the neighborhood
- Secure outdoor classroom/sensory garden
- Installing new ADA age-appropriate playground



Needs

- Update aging restrooms
- Replace galvanized domestic pipe
- Organize power to allow for emergency back-up generation
- Replacement of 58 year old windows
- Central air-conditioning

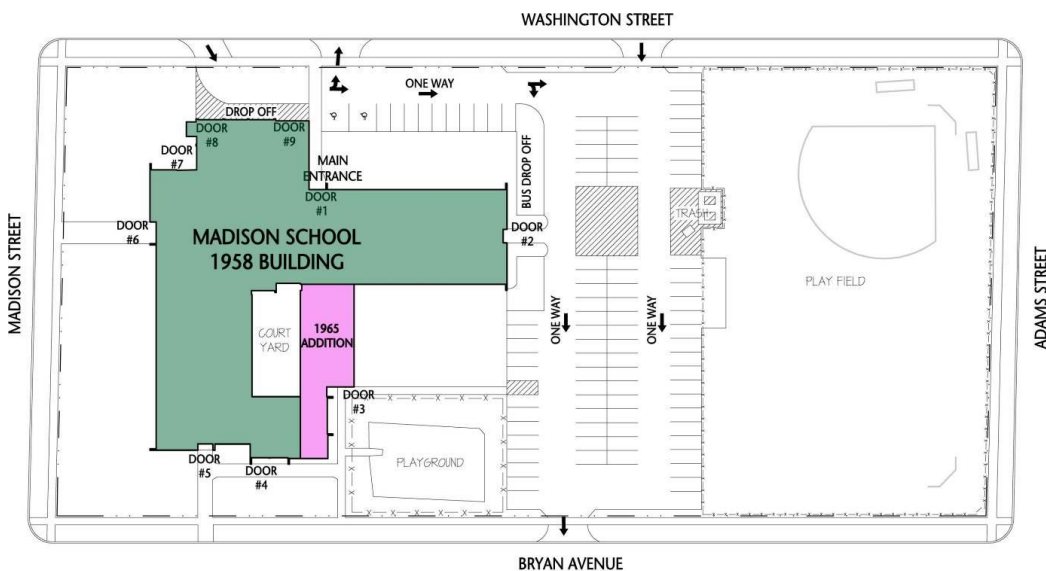

MADISON SITE PLAN



Edison Elementary School

246 S Fair • Elmhurst, IL 60126 • (630) 834-4272 • <http://edison.elmhurst205.org>
Built in 1956

Sq. Footage	Classrooms	Gyms/Multipurpose	Auditorium	Cafeteria	LRC/TRC	# of students
45,062	20	1 / 1	Stage in Gym	N/A	1 / 1	275

Total Acres	Acres/Playable fields	Lawns	Acres/blacktop play area	Athletic Fields	Linear Feet of Sidewalk	Parking Spots
5.6	1.9	2.9	0.2	1 ball field	1978	45

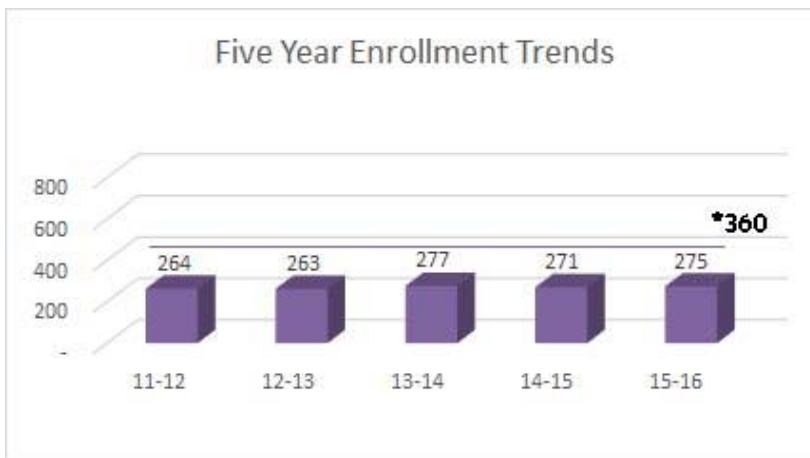

* **Capacity figures** based on national norms which are established by dividing the total square footage by # of students (ES = 120ft²)

	Type	Age	Condition
Heating	2 hot water boilers	18 years old	Good
Air-conditioning	Central Cooling plant with rooftop units for large areas	18 years old	Good
Electrical Service	1600 amp 208/120 service	18 years old	Excellent
Plumbing	Galvanized pipe	59 years old	Fair
Fire Suppression	Sprinkled in newest addition and multipurpose room		
Roof	All roofs are in good to very good condition		
Building Envelope	12,450 ft ² of masonry restoration needed		

Highlights

- Spacious and modern LRC/TRC
- Large adjacent gym and multipurpose rooms
- Fully secure outdoor classroom

Needs

- Re-organize power to allow for emergency back-up generation
- Masonry restoration

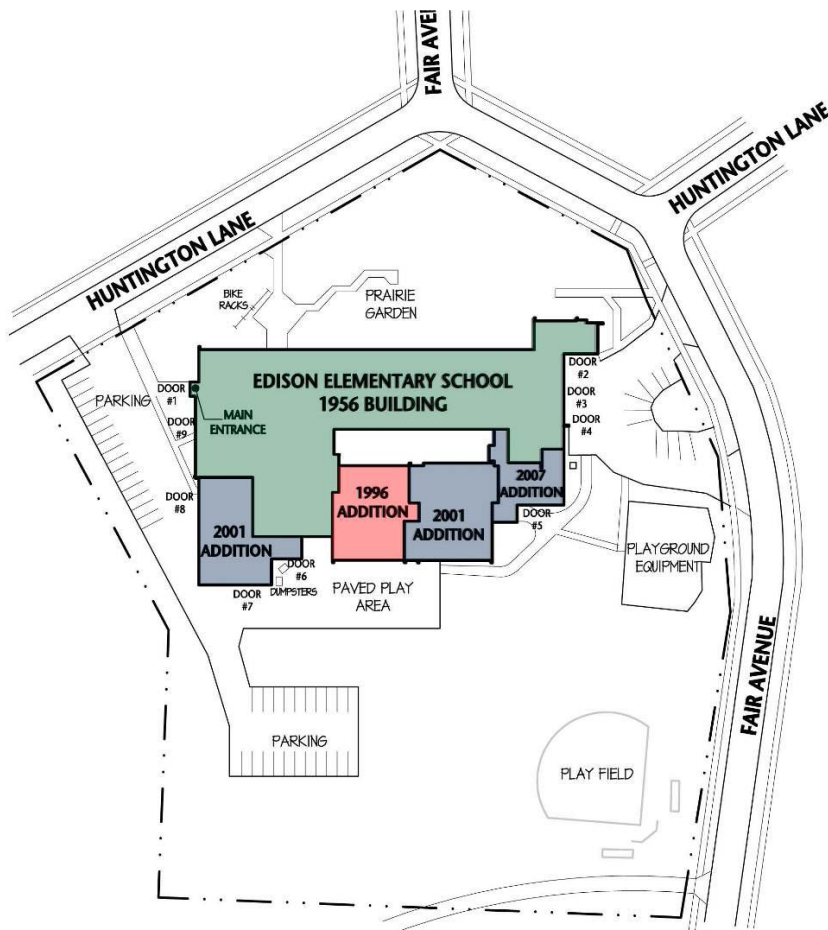

EDISON SITE PLAN



Emerson Elementary School

400 N. West • Elmhurst, IL 60126 • (630) 834-5562 • <http://emerson.elmhurst205.org>
Built in 1954

Sq. Footage	Classrooms	Gyms/Multipurpose	Auditorium	Cafeteria	LRC/TRC	# of students
67,039	28	1 / 1	Stage in Gym	N/A	1 / 1	459

Total Acres	Acres/Playable fields	Lawns	Acres/blacktop play area	Athletic Fields	Linear Feet of Sidewalk	Parking Spots
5	1.8	1.8	.4	N/A	1753	74

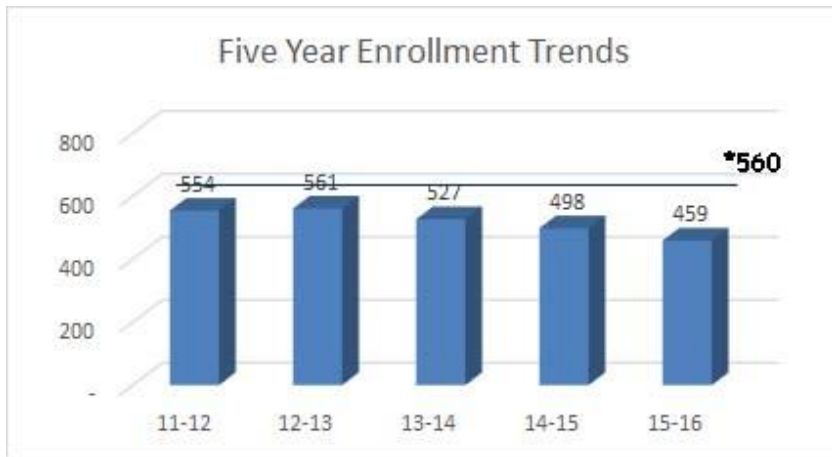

* **Capacity figures** based on national norms which are established by dividing the total square footage by # of students (ES = 120ft²)
Capacity issues also related to lunchroom.

	Type	Age	Condition
Heating	3 hot water package boilers	Average 12 years old	Excellent
Air-conditioning	Central Cooling plant 2 local roof top units	Expanded and updated 8 years ago 19 years old	Excellent good
Electrical Service	2000 amp 208/120 service	16 years old	Excellent
Plumbing	Galvanized pipe New additions copper	61 years old	Fair Excellent
Fire Suppression	Sprinkled in all additions		
Roof	All roofs are good to very good		
Building Envelope	12,725 ft ² of masonry restoration needed		

Highlights

- New multi-feature outdoor classroom/Oak grove
- Redesigned entrance and main office for efficiency & safety
- Large Kindergarten room with ample storage



Needs

- Masonry restoration

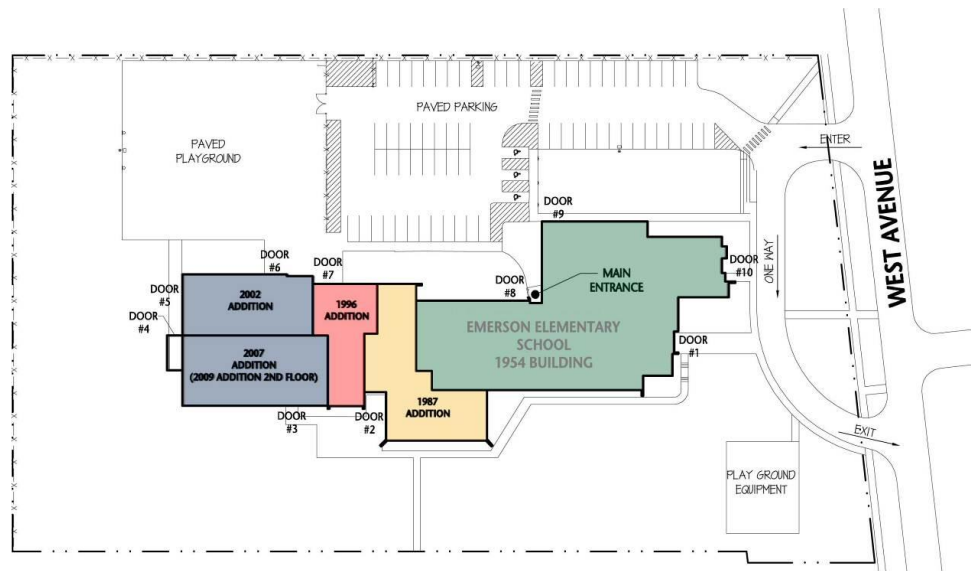

EMERSON SITE PLAN



Field Elementary School

295 Emroy • Elmhurst, IL 60126 • (630) 834-5313 • <http://field.elmhurst205.org>
Built in 1931

Sq. Footage	Classrooms	Gyms/Multipurpose	Auditorium	Cafeteria	LRC/TRC	# of students
58,520	24	1 / 1	Stage in Gym	N/A	1 / 1	413

Total Acres	Acres/Playable fields	Lawns	Acres/blacktop play area	Athletic Fields	Linear Feet of Sidewalk	Parking Spots
4.0	8	.8	.8	N/A	2371	65

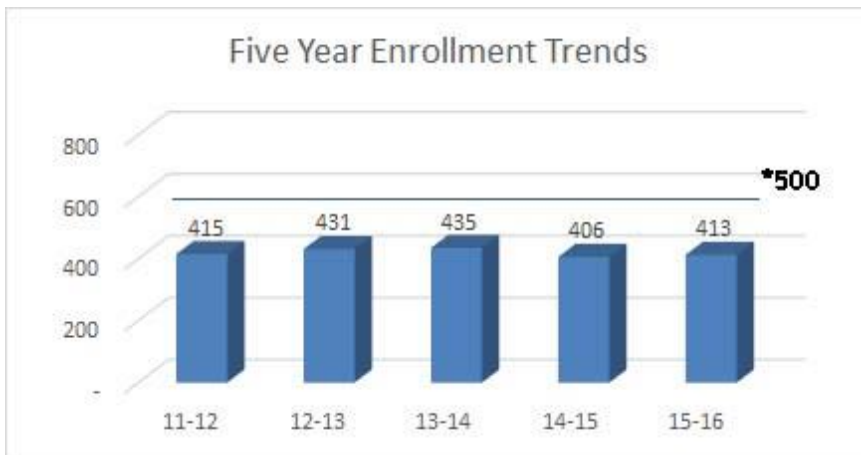

* **Capacity figures** based on national norms which are established by dividing the total square footage by # of students (ES = 120ft²)
Capacity issues also related to lunchroom.

	Type	Age	Condition
Heating	3 hot water package boilers	Average 14 years old	Good
Air-conditioning	Central Cooling plant 3 local rooftop units	18 years old Variable	Fair Fair
Electrical Service	2500 amp 208/120 service	18 years old	Excellent
Plumbing	Galvanized pipe Copper	18 years old (mostly) New additions	Good Excellent
Fire Suppression	Sprinkled in new addition only		
Roof	6,110 ft ² may need to be replaced in the 5 year range		
Building Envelope	Building envelope is in good condition		

Highlights

- Only elementary school with an auditorium
- Large classrooms with ample storage
- Updated playground with the District's only synthetic play surface



Needs

- Lunchroom is undersized for the student population
- Provide secure entrance
- Supply an elevator to as many levels as possible
- Improve function and drainage of detention area

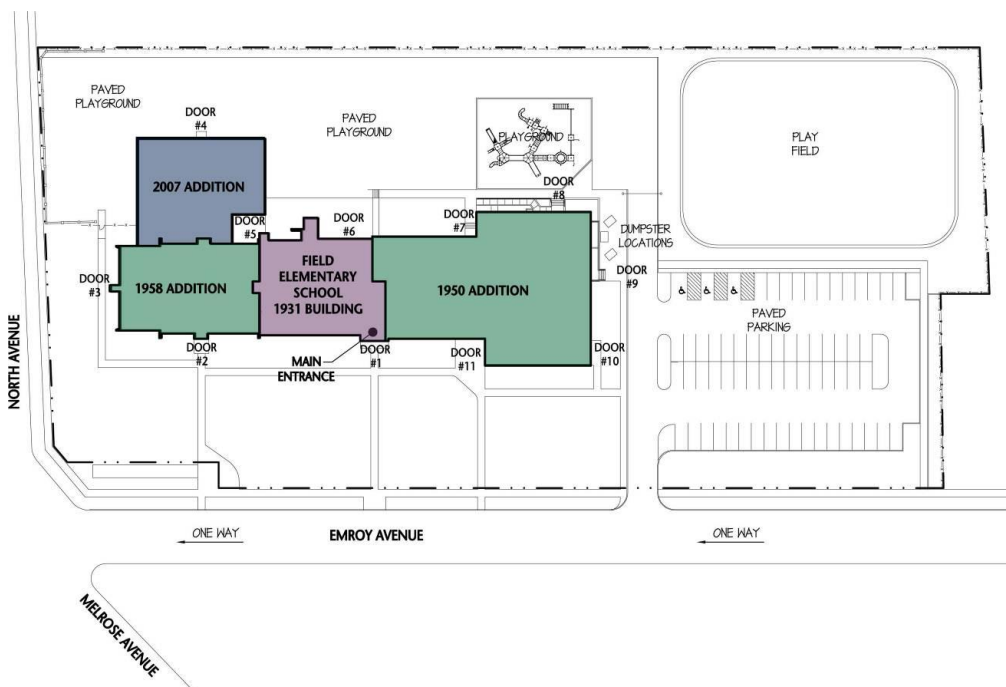

FIELD SITE PLAN



Fischer Elementary School

888 N. Wilson • Elmhurst, IL 60126 • (630) 832-8601 • <http://fischer.elmhurst205.org>
Built in 1957

Sq. Footage	Classrooms	Gyms/Multipurpose	Auditorium	Cafeteria	LRC/TRC	# of students
48,258	28	2	N/A	N/A	1 / 1	418

Total Acres	Acres/Playable fields	Lawns	Acres/blacktop play area	Athletic Fields	Linear Feet of Sidewalk	Parking Spots
5.1	0	.8	.5	Adjacent park district field	1585	77

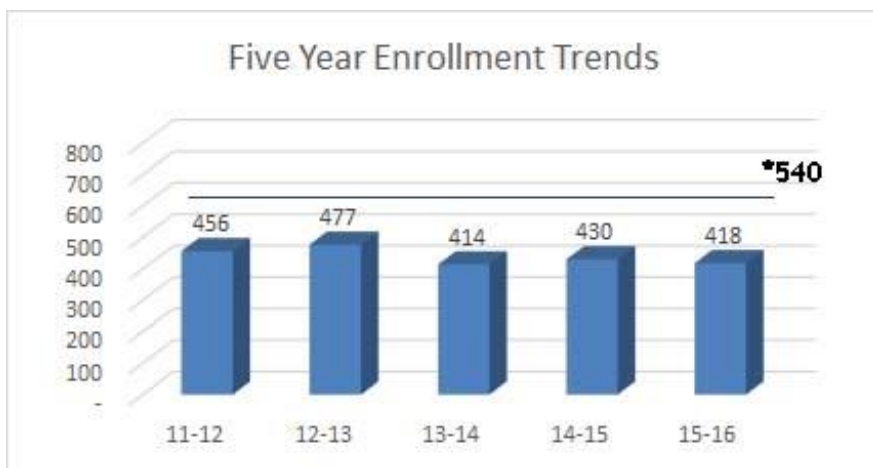

* **Capacity figures** based on national norms which are established by dividing the total square footage by # of students (ES = 120ft²)
Capacity issues also related to lunchroom.

	Type	Age	Condition
Heating	6 hot water package boilers	Average 14 years old	Good
Air-conditioning	Central Cooling plant 2 local rooftop units	Expanded and updated 8 years ago 19 years old	Good Fair
Electrical Service	1000 amp 208/120 service	19 years old	Excellent
Plumbing	Mostly Copper pipe	8 years old	excellent
Fire Suppression	Sprinkled in all additions		
Roof	All roofs are in good condition		
Building Envelope	Building envelope is in good to very good condition		

Highlights

- Adequate and well-designed parking
- Improved exterior appearance
- Very good ADA accessibility
- Large dedicated TRC

Needs

- Replace HVAC delivery system
- Replace original galvanized domestic water pipes
- Lunch area is not large enough and lacks air-conditioning
- Re-organize power to allow for emergency back-up generation
- Provide a stage

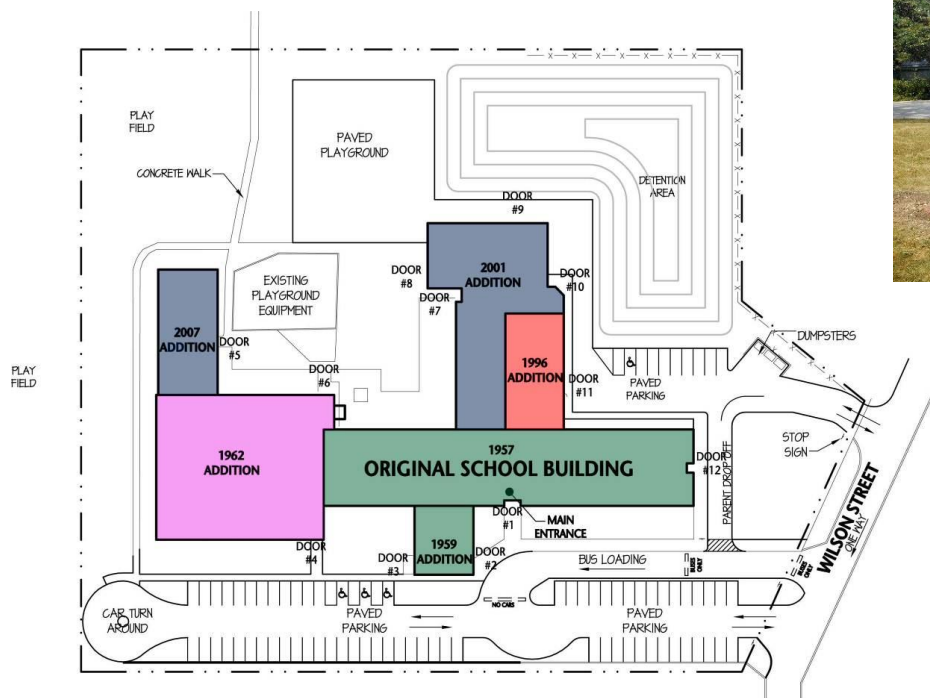

FISCHER SITE PLAN



Hawthorne Elementary School

145 Arthur • Elmhurst, IL 60126 • (630) 834-4541 • <http://hawthorne.elmhurst205.org>
Built in 1928

Sq. Footage	Classrooms	Gyms/Multipurpose	Auditorium	Cafeteria	LRC/TRC	# of students
78,470	37	2	Stage in Gym	N/A	1 / 1	508

Total Acres	Acres/Playable fields	Lawns	Acres/blacktop play area	Athletic Fields	Linear Feet of Sidewalk	Parking Spots
2.9	0	.4	.7	N/A	1428	59

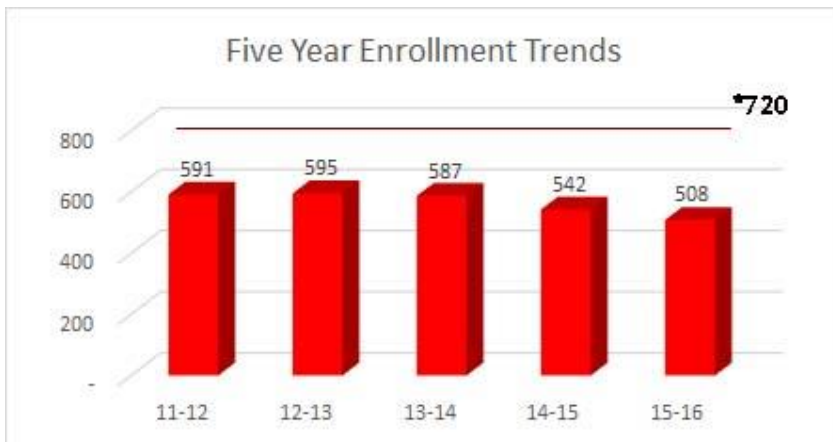

* **Capacity figures** based on national norms which are established by dividing the total square footage by # of students (ES = 120ft²)

	Type	Age	Condition
Heating	4 hot water package boilers	7 years old	Excellent
Air-conditioning	Central Cooling plant	7 years old	Fair
	Roof top on the new gym	14 years old	Fair
Electrical Service	1200 amp 480/277 service	7 years old	Excellent
Plumbing	Copper Pipe	7 years old	Excellent
Fire Suppression	Completely Sprinkled		
Roof	All areas are in excellent condition		
Building Envelope	Building envelope is in very good condition		

Highlights

- Addition and remodeling preserved the historical aspects of the building
- Spacious and classic library
- Large dedicated TRC
- Award-winning outdoor classroom and green space



Needs

- Locate additional parking

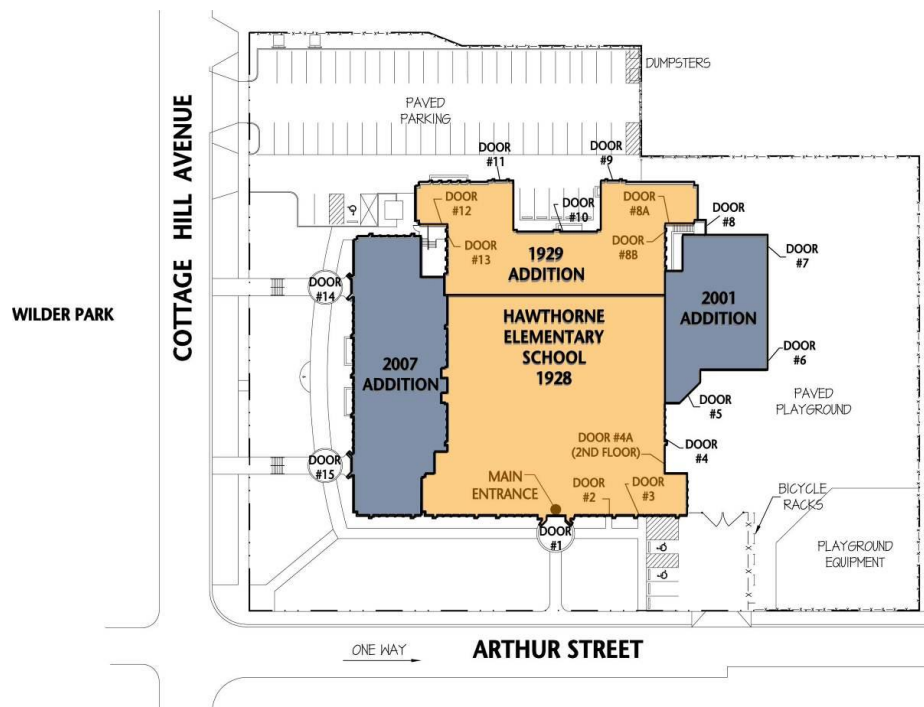
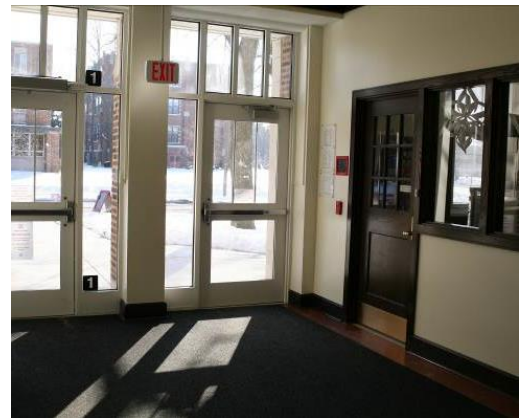

HAWTHORNE SITE PLAN



Jackson Elementary School

925 Swain • Elmhurst, IL 60126 • (630) 834-4544 • <http://jackson.elmhurst205.org>
Built in 1952

Sq. Footage	Classrooms	Gyms/Multipurpose	Auditorium	Cafeteria	LRC/TRC	# of students
54,999	26	2	N/A	N/A	1 / 1	421

Total Acres	Acres/Playable fields	Lawns	Acres/blacktop play area	Athletic Fields	Linear Feet of Sidewalk	Parking Spots
4.6	1.3	2.1	.4	2 small soccer field	2565	63

Five Year Enrollment Trends



* **Capacity figures** based on national norms which are established by dividing the total square footage by # of students (ES = 120ft²)

	Type	Age	Condition
Heating	3 hot water package boilers	18 years old	Good
Air-conditioning	Window units	Variable	Variable
	2 local rooftop units	19 years old	Fair
Electrical Service	1200 amp 208/120 service	16 years old	Excellent
Plumbing	Galvanized pipe	63 years old	Fair
	Copper	New additions	Excellent
Fire Suppression	Sprinkled in new addition only		
Roof	1,595 ft ² may need to be replaced in the 5 to 10 year range (re-evaluate in 5 years).		
Building Envelope	14,445 ft ² of masonry restoration needed		

Highlights

- Large attractive LRC
- Large, fenced green space adjacent to playground
- Dedicated art room with connected dedicated kiln room

Needs

- Masonry restoration
- Re-blacktop the entrance and parking lot
- Central air-conditioning

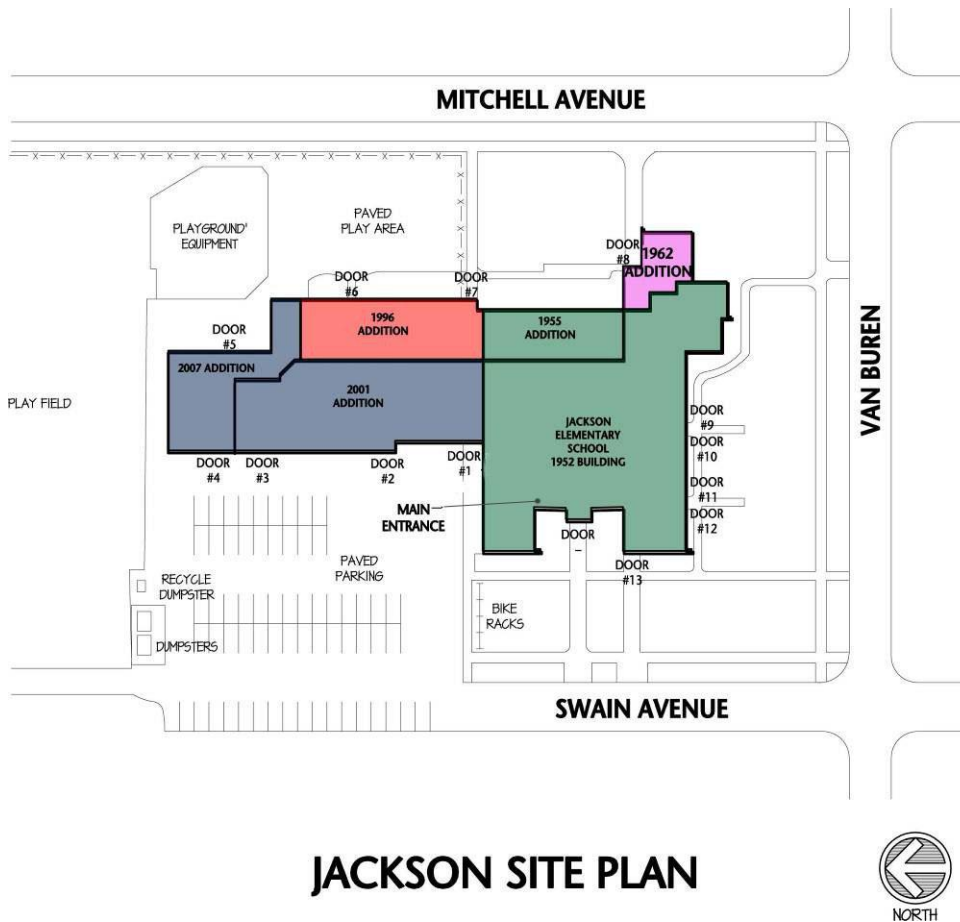

Jefferson Elementary School

360 E Crescent • Elmhurst, IL 60126 • (630) 834-6261 • <http://jefferson.elmhurst205.org>
Built in 1954

Sq. Footage	Classrooms	Gyms/Multipurpose	Auditorium	Cafeteria	LRC/TRC	# of students
50,307	22	2	Stage in gym	N/A	1 / 1	374

Total Acres	Acres/Playable fields	Lawns	Acres/blacktop play area	Athletic Fields	Linear Feet of Sidewalk	Parking Spots
4.1	1.2	2	.5	Ball field	1275	59

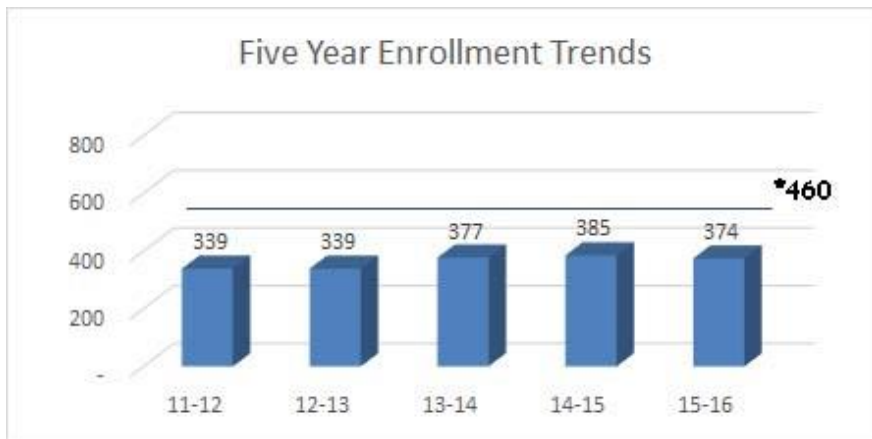

* **Capacity figures** based on national norms which are established by dividing the total square footage by # of students (MS = 120ft²)

	Type	Age	Condition
Heating	2 hot water boilers	61 years old	Good
Air-conditioning	Window units	Variable	Variable
	6 dx cooling units	8 years old	Very Good
	2 local rooftop units	19 and 10 years old	Fair
Electrical Service	1200 amp 208/120 service	18 years old	Excellent
Plumbing	Galvanized pipe	61 years old	Fair
	Copper	New additions	Excellent
Fire Suppression	Sprinkled in newest addition and multi-purpose rooms		
Roof	2,560 ft ² should be replaced; 9060 s.f. should be replaced within the 5 to 10 years		
Building Envelope	11,300 ft ² of masonry restoration needed		

Highlights

- Open spaces and play areas around the school
- Updated, attractive LRC
- Spacious new TRC

Needs

- Provide an ADA accessible art room
- Central air-conditioning

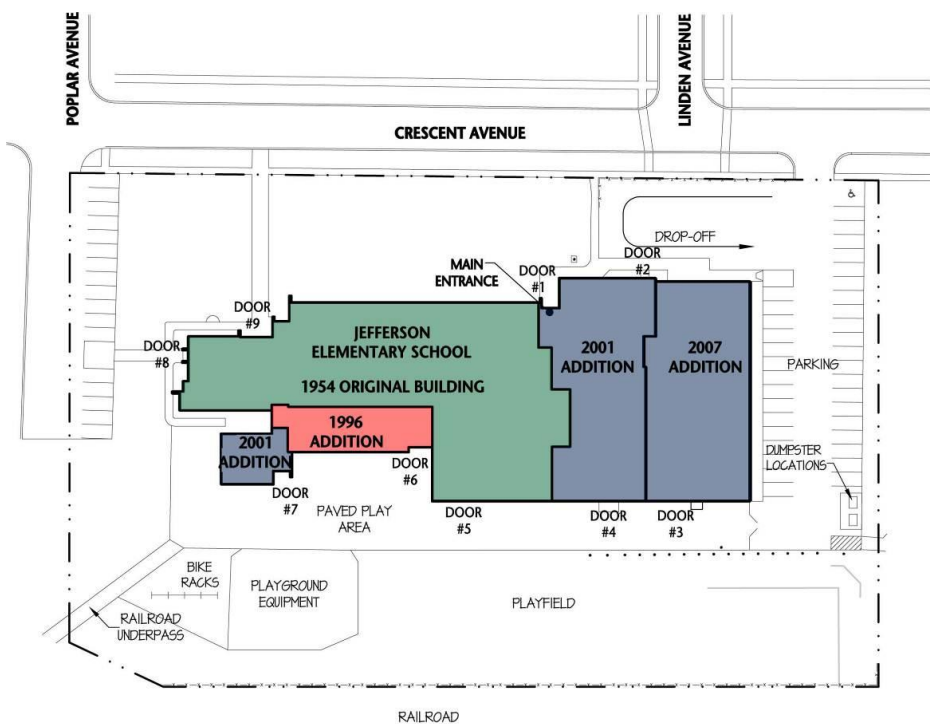

JEFFERSON SITE PLAN



Lincoln Elementary School

565 S. Fairfield • Elmhurst, IL 60126 • (630) 834-4548 • <http://lincoln.elmhurst205.org>
Built in 1915

Sq. Footage	Classrooms	Gyms/Multipurpose	Auditorium	Cafeteria	LRC/TRC	# of students
64,236	31	1	Stage in gym	N/A	1 combined	554

Total Acres	Acres/Playable fields	Lawns	Acres/blacktop play area	Athletic Fields	Linear Feet of Sidewalk	Parking Spots
3.5	.9	1	.8	2 small ball field	2061	81

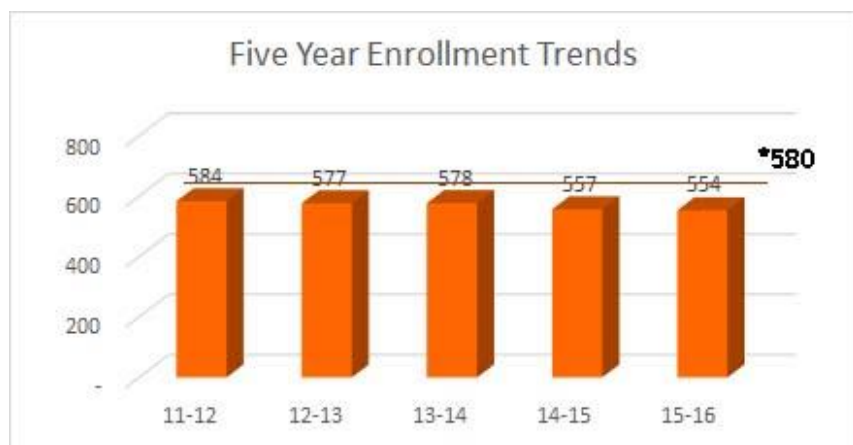

* **Capacity figures** based on national norms which are established by dividing the total square footage by # of students (ES = 120ft²) Capacity issues also related to lunchroom.



Lincoln is the District's oldest existing building

	Type	Age	Condition
Heating	3 steam boilers	23 and 17 years old	Good
Air-conditioning	Window units 2 rooftop units	Variable 19 years old	Variable Fair
Electrical Service	1200 amp 208/120 service	28 years old	Fair
Plumbing	Mostly Galvanized pipe	58 years old	Poor
Fire Suppression	Sprinkled in all post 2000 additions		
Roof	12,860 ft ² may need to be replaced in the 5 year range		
Building Envelope	Significant masonry demolition and restoration of original building needed within 5 years		

Highlights

- Unique features in wood finishes and masonry
- Creatively designed and attractive LRC
- Large Kindergarten rooms with ample storage

Needs

- Replace original galvanized domestic water pipes
- Replace ceiling tile & grid
- Significant masonry demolition and restoration
- 12,860 ft² roof to be replaced.
- Update aging restrooms
- Replace failing interior downspouts
- Replace entire steam heating plant and HVAC delivery systems
- Increase the space available for the lunch program
- Provided a dedicated space for the TRC
- Relocate playground adjacent to green space
- Additional classroom space
- Reorganize building for ADA accessibility
- Central air-conditioning

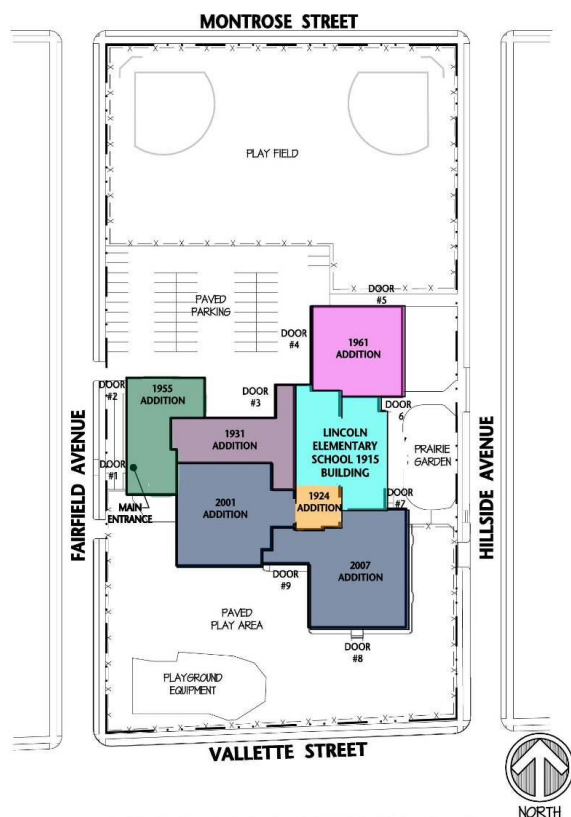

LINCOLN SITE PLAN

Bryan Middle School

111 Butterfield Rd. • Elmhurst, IL 60126 • (630) 617-2350 • <http://bryan.elmhurst205.org>

Built in 1960

Sq. Footage	Classrooms	Gyms/Multipurpose	Auditorium	Cafeteria	LRC/TRC	# of students
109,119	45	1 / 1 fitness	1	Yes	1 / 2	702

Total Acres	Acres/Playable fields	Lawns	Acres/blacktop play area	Athletic Fields	Linear Feet of Sidewalk	Parking Spots
13	4	5.1	N/A	2 softball fields	5078	138

Five Year Enrollment Trend



* **Capacity figures** based on national norms which are established by dividing the total square footage by # of students (MS = 140ft²)



	Type	Age	Condition
Heating	4 hot water boilers	18 years old	Very Good
Air-conditioning	Central Cooling plant Some local rooftop units	7 years old	Excellent
Electrical Service	2500 amp 208/120 service	7 years old	Excellent
Plumbing	Copper pipe	8 years old	Excellent
Fire Suppression	Sprinkled in newest addition and stage		
Roof	17,500 ft ² may need to be replaced in the 5 to 10 year range (re-evaluate in 5 years).		
Building Envelope	Building envelope is in good condition		

Highlights

- Outstanding and large industrial tech area
- Well-designed remodeled Family Consumer Science food lab
- Excellent stage and auditorium with balcony
- Dedicated fitness room



Needs

- Provide secure entrance
- Organize power to allow for emergency back-up generation
- Supply adequate and sufficient science lab space
- Update aging non-accessible restrooms
- Update aging auditorium lighting and sound

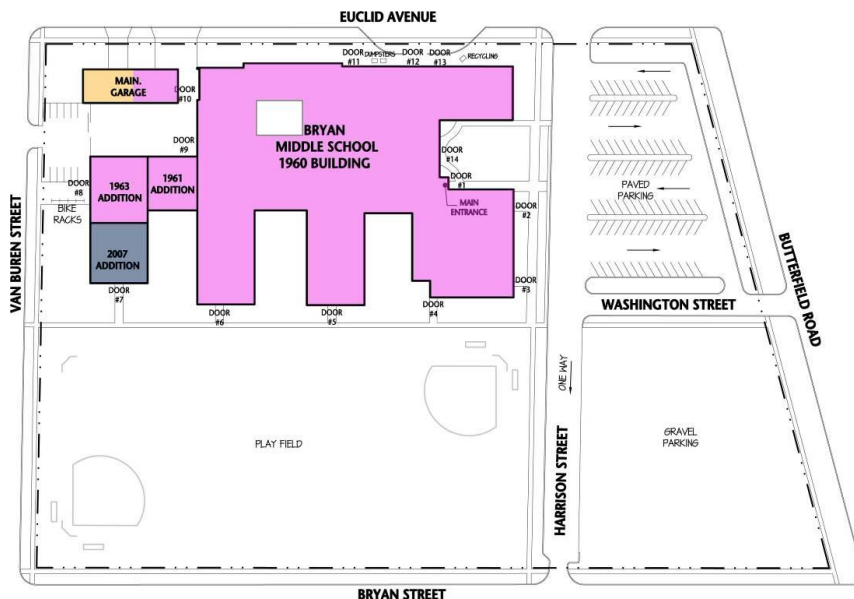

BRYAN SITE PLAN



Churchville Middle School

155 Victory Parkway • Elmhurst, IL 60126 • (630) 832-8682 • <http://churchville.elmhurst205.org>
Built in 1970

Sq. Footage	Classrooms	Gyms/Multipurpose	Auditorium	Cafeteria	LRC/TRC	# of students
101,850	38	2 / 1 fitness	Stage in gym	Yes	1 / 2	542

Total Acres	Acres/Playable fields	Lawns	Acres/blacktop play area	Athletic Fields	Linear Feet of Sidewalk	Parking Spots
9.6	5.7	5.1	N/A	Field behind school	2078	87

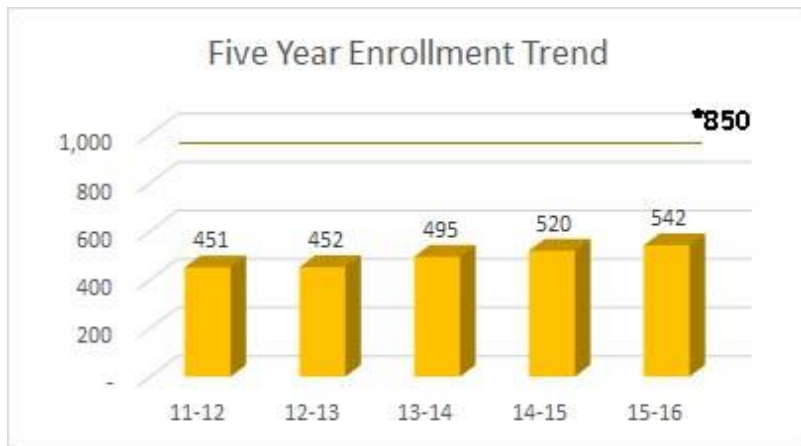

* **Capacity figures** based on national norms which are established by dividing the total square footage by # of students (MS = 140ft²)

	Type	Age	Condition
Heating	3 hot water boilers	45 years old	Good
Air-conditioning	Central Cooling plant Roof top unit on gym	Expanded and updated 8 years ago	Good Good
Electrical Service	2000 amp 208/120 service	45 years old	Poor
Plumbing	Galvanized pipe	45 years old Some runs and fittings replaced 4 years ago	Poor
Fire Suppression	Sprinkled in newest addition and state and east gym		
Roof	17,090 ft ² may need to be replaced in the 5 to 10 year range (re-evaluate in 5 years).		
Building Envelope	Building envelope is in good to very good condition		

Highlights

- Two large gyms
- Prairie/diversity garden/oak savanna are unique outdoor areas
- Cutting-edge Media:scape Learn Lab

Needs

- Replace original galvanized domestic water pipes
- Replace ceiling tile & grid
- Remove canopy, replace and reorganize parking lot
- Provide building automated controls to District standard
- Update aging restrooms
- Increase available cafeteria dining space
- Update electrical service and distribution
- Replace aging inefficient heating plant
- Build a dedicated auditorium

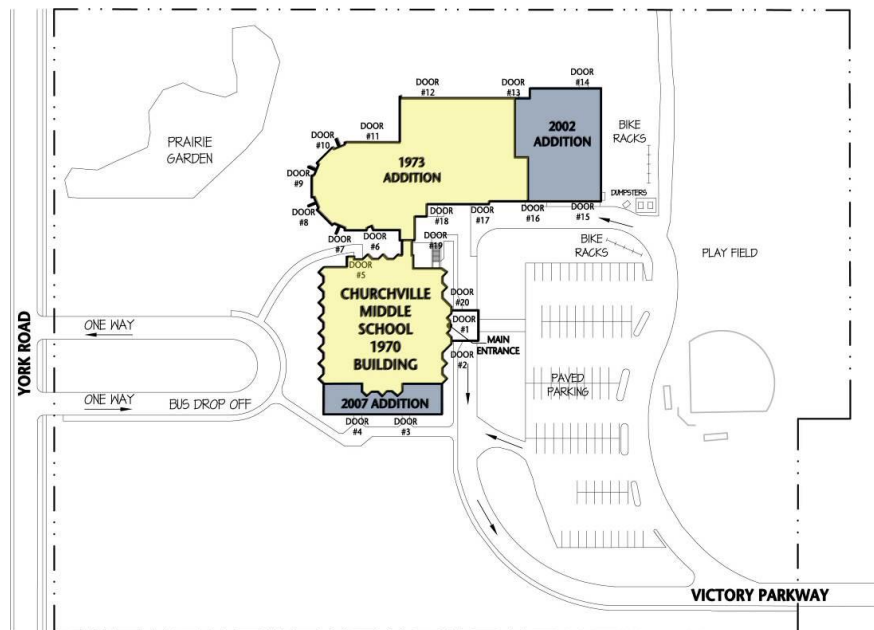

CHURCHVILLE SITE PLAN



Sandburg Middle School

345 E St. Charles Rd • Elmhurst, IL 60126 • (630) 834-4534 • <http://sandburg.elmhurst205.org>
Built in 1950

Sq. Footage	Classrooms	Gyms/Multipurpose	Auditorium	Cafeteria	LRC/TRC	# of students
139,866	47	1 / 1 fitness	1	Yes	1 / 2	719

Total Acres	Acres/Playable fields	Lawns	Acres/blacktop play area	Athletic Fields	Linear Feet of Sidewalk	Parking Spots
9.7	3	4.4	N/A	1 large ball field	1982	194

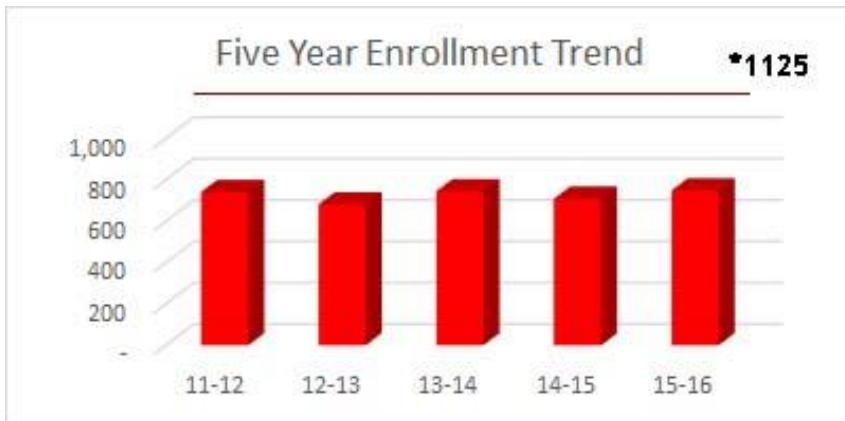

* **Capacity figures** based on national norms which are established by dividing the total square footage by # of students (MS = 140ft²)
Capacity issues are also related to Physical Education.

	Type	Age	Condition
Heating	4 hot water boilers	18 years old	Fair
Air-conditioning	Central Cooling plant	Expanded and updated 8 years ago	Very Good
Electrical Service	2500 amp 480/277 service	18 years old	Excellent
Plumbing	Copper pipe	18 years old	Excellent
Fire Suppression	Sprinkled in newest addition and auditorium		
Roof	38,220 ft ² may need to be replaced in the 5 to 10 year range (re-evaluate in 5 years)		
Building Envelope	Building envelope is in fair to excellent condition		

Highlights

- Excellent auditorium with balcony highly utilized by the school and the community
- Large and newly-remodeled Family Consumer Science food lab
- Science labs
- Spartan TV Studio



Needs

- Re-pave parking lot
- Large areas of roof to be replaced
- Provide secure entrance
- Organize power to allow for emergency back-up generation
- Update aging auditorium lighting and sound
- Relocate and/or redesign the Main Office to provide for a secure entrance and better ADA access to the building

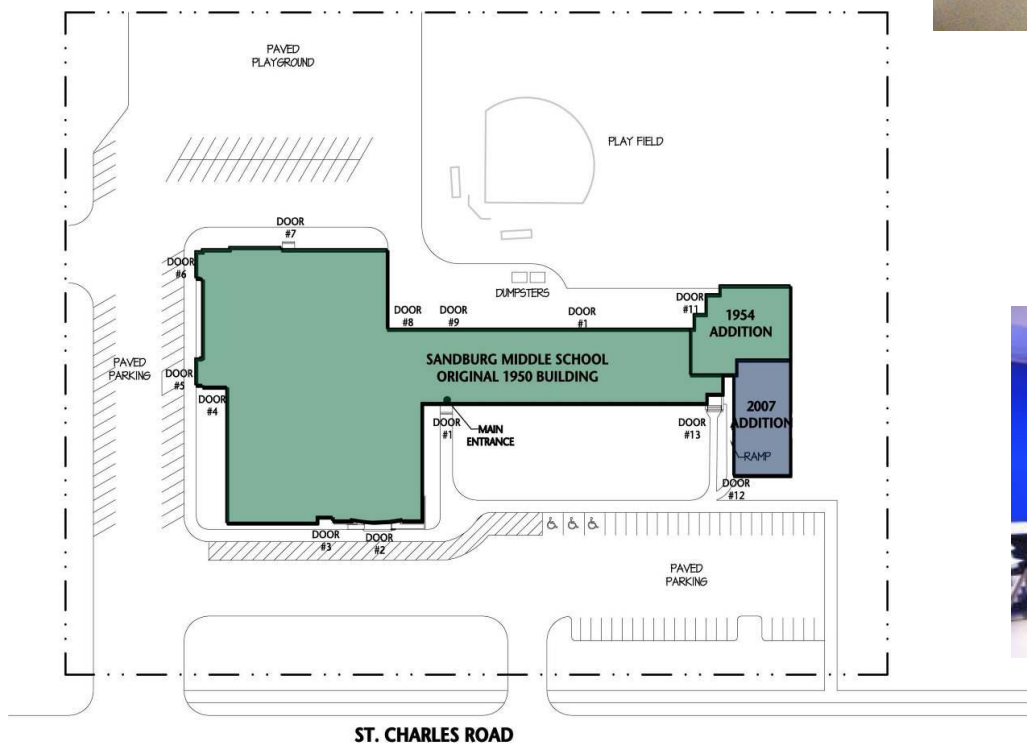

SANDBURG SITE PLAN



York Community High School

355 W. St. Charles Rd ● Elmhurst, IL 60126 ● (630) 617-2400 ● <http://york.elmhurst205.org>

Built in 1926

Sq. Footage	Classrooms	Gyms/Multipurpose	Auditorium	Cafeteria	LRC/TRC	# of students
711,701	126	2 / 1 fitness 1 spin 1 fieldhouse 1 aquatic	1 / 1 Black box	yes	12 / 20	2647

Total Acres	Acres/Playable fields	Lawns	Acres/blacktop play area	Athletic Fields	Linear Feet of Sidewalk	Parking Spots
37	13	12	N/A	1 multi use stadium Baseball field 3 practice fields	9221	477

Five Year Enrollment Trend

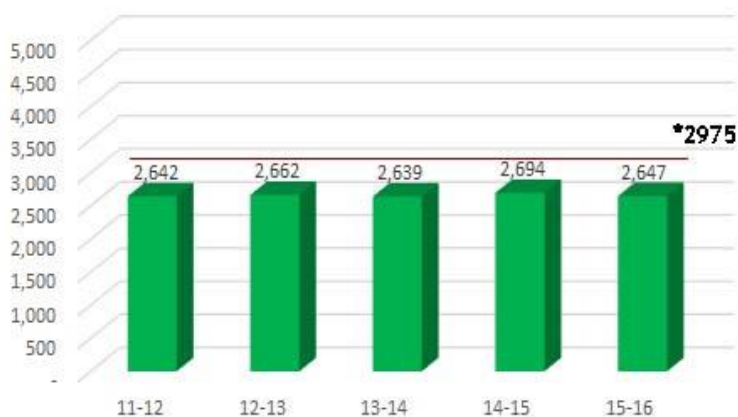

* **Capacity figures** based on national norms which are established by dividing the total square footage by # of students (HS = 160ft²)



	Type	Age	Condition
Heating	23 hot water package boilers	Average 13 years old	Good
Air-conditioning	Central Cooling plant	14 years old	Good
Electrical Service	5000 amp 480/277 service	14 years old	Excellent
Plumbing	Mostly Copper pipe	14 years old	Excellent
Fire Suppression	Completely sprinkled		
Roof	114,420 ft ² should be replaced within 5 years		
Building Envelope	Building envelope is in fair to very good condition with some specific repairs needed		

Highlights

- Stunning commons area
- Fully functional FCS commercial kitchen
- Large and safe industrial tech areas
- Numerous well designed science labs
- Cutting edge Media:scape Learn Lab
- Large heavily used field house
- Field Turf transformed football stadium into the District's largest classroom

Needs

- Replace balcony bleachers
- Update building automated HVAC/Lighting controls
- Large areas of roof replacement
- Supply additional lockers
- Provide larger better designed areas for special needs students
- Re-blacktop many areas
- Replace obsolete fencing north of St. Charles Road
- Update aging auditorium lighting and sound

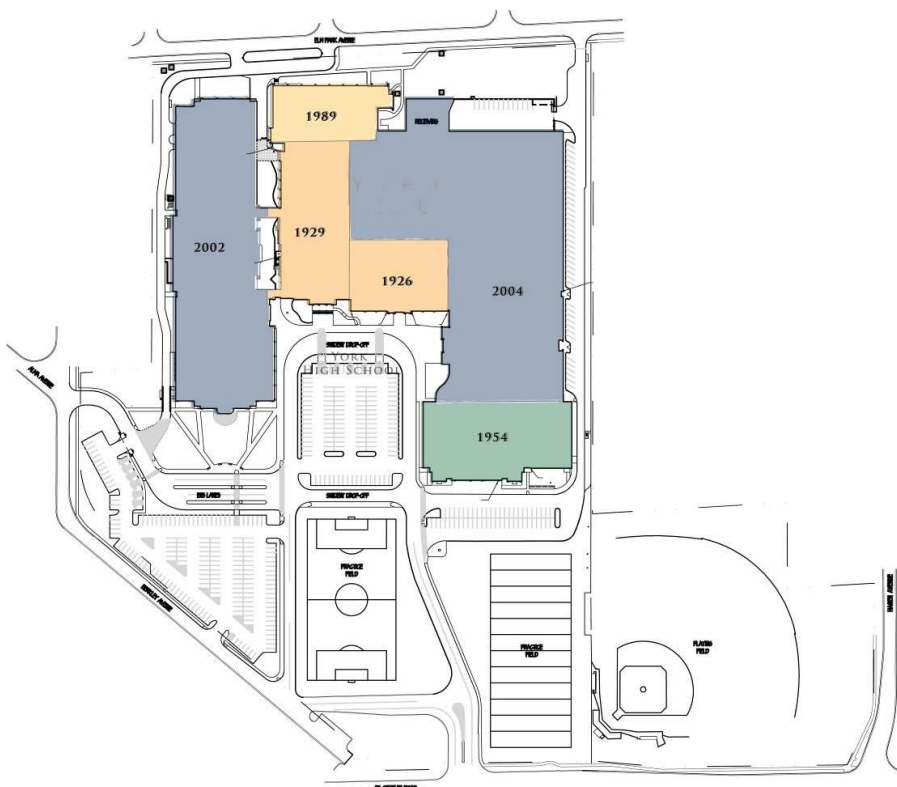
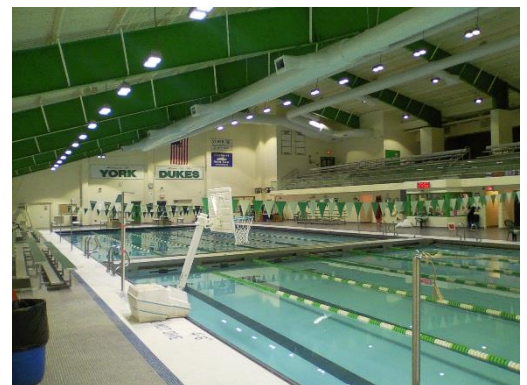

Capital Improvements Since 2006

District Wide	2008: Conversion to web based building automated controls (except York), new security card access system (except York).
Edison	2007: Remodeled and expanded TRC and LRC.
Emerson	2007: 3 new classrooms, 1 new office/small instruction room, new bank of girl's and boy's restroom, 2009: 5 new classrooms, 2 new offices/small instruction rooms, 2 individual use restrooms, expanded blacktop including increased parking and redesigned play area separated by a new fence, new site fencing, new exterior lighting.
Field	2007: 4 new classrooms, 1 office/small instruction room, new bank of girl's and boy's restrooms, relocated playground, detention area, new parking lot and lighting 2008: electrical update for portable emergency generator 2010: major masonry restoration primarily of west elevation.
Fischer	2007: 3 new classrooms, 1 small instruction space, new black top play area, expanded and redesigned parking, new exterior lighting, re-landscaped, detention area, updated fixtures in two sets of rest rooms.
Hawthorne	2008: 58,000 square feet completely renovated and updated, 20,000 square feet of new construction, new permeable paver parking lot with underground storm detention, new landscaping, new site fencing, new windows, exterior doors, complete tuck pointing and masonry restoration, new emergency generator. 2015: Replaced roof.
Jackson	2007: 2 new classrooms, new bank of girl's and boy's restrooms, 2008: new perimeter fencing, new fence separating play area from parking.
Jefferson	2007: 6 new classrooms, new TRC, new bank of girl's and boy's restrooms, two new small offices/small instruction rooms, renovated second kindergarten, parking lot redesign and resurfacing, 2008: new exterior lighting, electrical update for portable emergency generator.
Lincoln	2007: 5 new classrooms, new kindergarten, 2 new offices/small instruction rooms, new bank of girl's and boy's restrooms, new perimeter fencing, 2008: new exterior lighting, electrical update for portable emergency generator 2012: significant tuck pointing and patching.
Madison	2014: Provided domestic hot water and sanitary lines to every classroom. 2015: Significant tuck-pointing and weatherproofing
Board Office	2009: Purchase of AT&T building, complete remodel and restoration of 23,000 square feet.

Bryan	2007: 4 new classrooms, 1 expanded classroom, domestic water piping replaced throughout the building, 1 conference room, 2008: air-conditioning added, 2009: new and redesigned parking and bus loading area, remodeled foods lab. 2013: Replaced P.E. lockers and installed new automated bleachers. 2015: Significant tuck-pointing and weatherproofing
Churchville	2007: 6 new classrooms, 2 large instructional spaces, new lobby, new bank girl's and boy's restrooms, pod area remodeled to include 5 new classrooms and two new computer labs, significant masonry repairs and rebuilding of piers, 2009: remodeled foods lab. 2013: Replaced P.E. lockers and installed new automated bleachers.
Sandburg	2007: 6 new classrooms including 2 full science labs, 1 new office/small instruction room, remodeled and expanded bank of girl's and boy's restrooms, 2008: new exterior lighting, 2009: all new hallway lockers, remodeled foods lab. 2013: Replaced P.E. lockers.
Transition Center	2009: Complete remodel and restoration of 3,600 square feet.
York	2008: Aquatic Center bleachers replaced, Aquatic Center lockers replaced, baseball backstop netting, 2009: field turf football/soccer field, large underground storm detention for stadium, replace track surface, new stadium fencing, new stadium entry plaza, 2011: new neighbor friendly efficient stadium lighting, improvements to stadium sound system. 2013: Aquatic Center Project: Replaced roof, installed energy efficient lighting, fixed pool leak, insulated ductwork and entirely painted. 2015: New building automated controls for HVAC and lighting

School	Capacity	15-16	16-17	17-18	18-19	19-20	20-21
Bryan	975	702	718	727	718	706	743
Sandburg	1,125	749	714	686	665	683	658
Churchville	850	542	516	509	482	454	416
York	2,975	2,647	2,703	2,790	2,813	2,868	2,847
Fischer	540	418	423	408	400	415	417
Edison	360	275	287	307	320	310	319
Emerson	560	459	456	446	451	463	471
Field	500	413	446	454	476	497	524
Hawthorne	720	508	507	503	503	510	514
Jackson	480	421	425	428	437	433	405
Jefferson	460	374	377	389	391	398	407
Lincoln	580	554	546	554	566	567	553
Madison*	330	248	246	246	246	246	246

*Madison capacity is based on 15 students per half-day class.

Facilities Highlights

School	Sq. Footage	Classrooms	Gyms/ Multipurpose	Auditorium	Cafeteria	LRC/TRC	# of students	Total Acres	Parking Spots
Madison	31,178	14	1	Stage in gym	No	N/A	248	4.0	81
Edison	45,062	20	1/1	Stage in gym	No	1/1	271	5.6	44
Emerson	67,039	28	1/1	Stage in gym	No	1/1	498	5.0	74
Field	58,520	24	1/1	yes	No	1/1	406	4.0	65
Fischer	48,258	28	2	N/A	No	1/1	430	5.1	77
Hawthorne	78,470	37	2	Stage in gym	No	1/1	542	2.9	59
Jackson	54,999	26	2	Stage in gym	No	1/1	411	4.6	68
Jefferson	50,307	22	2	Stage in gym	No	1/1	385	4.1	59
Lincoln	64,236	31	1	Stage in gym	No	1 combined	557	3.5	51
Bryan	109,119	45	1/1 Fitness	1	Yes	1 / 2	692	13	138
Churchville	101,850	38	2/1 Fitness	Stage in gym	Yes	1 / 2	520	9.6	87
Sandburg	139,866	47	1/1 Fitness	1	Yes	1 / 2	709	9.7	194
York	711,701	126	2 / 1 Fitness 1 spin room 1 field house 1 aquatic	1 / 1 Black box	yes	Learning Commons / 20	2694	37.0	477
Transition Center	**Rental Property								
District Office	23,000	8 meeting rooms	N/A	N/A	N/A	N/A	N/A	1.4	88

Color codes for Additions (by decade)

1910-1919	1920-1929	1930-1939	1940-1949	1950-1959
1960-1969	1970-1979	1980-1989	1990-1999	2000-2010

B Churchville

C Sandburg

A Bryan

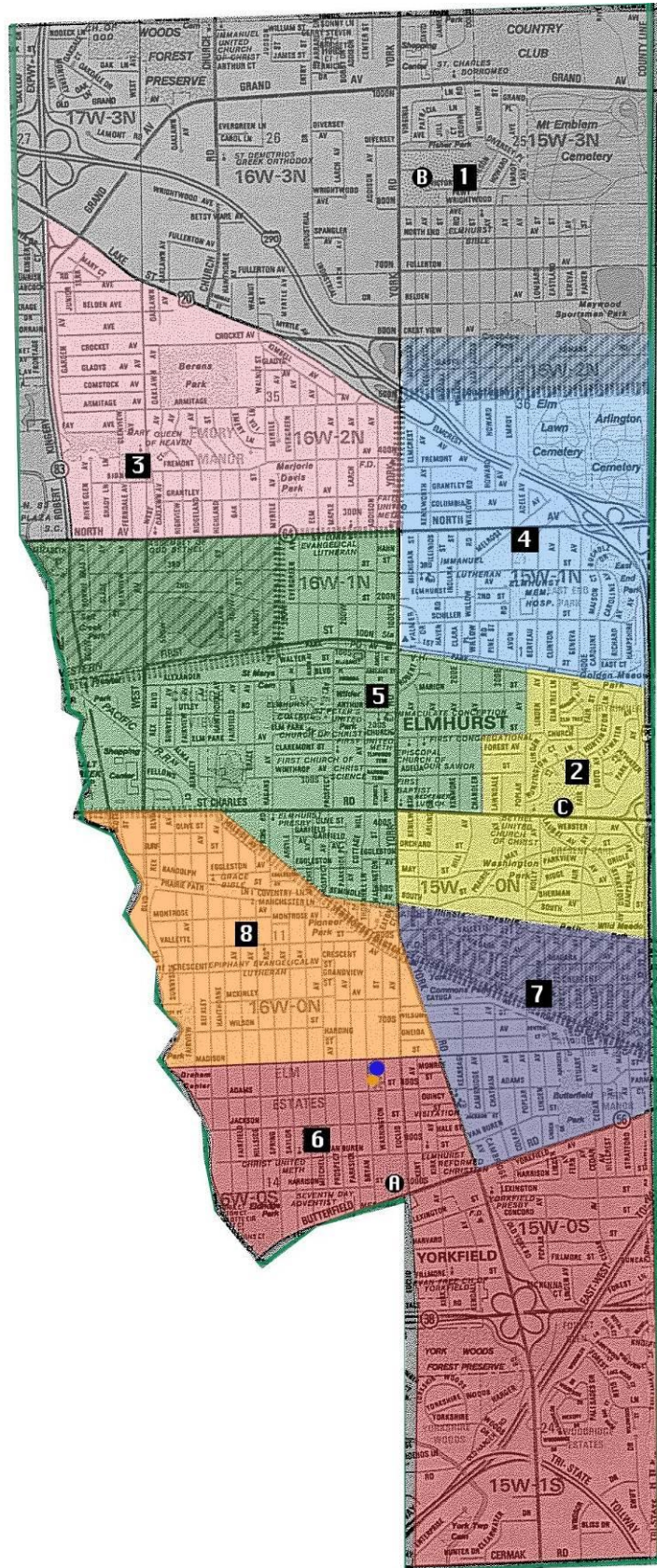

1 Conrad Fischer Elementary

3 Emerson Elementary

4 Field Elementary

5 Hawthorne Elementary

2 Edison Elementary

7 Jefferson Elementary

8 Lincoln Elementary

6 Jackson Elementary

*Facilities at a Glance is a 2015 Award of Excellence winner in the Illinois
Chapter of the National School Public Relations Association (INSPRA)
Communications Contest in the Special Purpose category.*

Elmhurst Community Unit School District 205

Facilities at a Glance

2015-2016

11/30/2015

